

# SERIES 215ML/22

## MAT-REINFORCED LINING SYSTEM FOR MEMBRANE FILTER TANKS

With the advancement of membrane filter technology, many treatment facilities are moving to ultrafiltration or microfiltration systems, whether for raw water or for wastewater in the form of an ultrafiltration membrane or membrane bioreactor (MBR). These systems provide a high quality effluent with a much smaller plant footprint. Immersion-type filters which require tanks or basins are a popular choice due to their increased efficiency and ease of maintenance.

However, the processes involved with operating and maintaining the filters, whether in water or wastewater treatment, can subject concrete tank linings to a unique set of demands. Tnemec, a leader in protective coatings for water and wastewater treatment, developed the Series 215ML/22 Mat-Reinforced Lining System to protect concrete from aggressive cleaning methods, impact, and thermal shock from elevated backwash/backflush temperatures, while ensuring safe contact with drinking water.

### FEATURES AND BENEFITS

- Penetrating concrete primer
- 100% solids epoxy basecoat and topcoat
- Fiberglass reinforcement
- Chemical and permeation resistant
- Resistant to impact and abrasion from cassette movement
- Resistant to thermal shock from elevated temperature backwashing or backflushing
- 100% NSF/ANSI Std. 61 certified

**System Details** 



## SYSTEM DETAILS

Every coating in Tnemec's Series 215ML/22 Mat-Reinforced Chemical-Resistant Lining System is NSF/ANSI Standard 61-certified—from the primer, to the fiberglass-reinforced intermediate coat, to the topcoat. The lining consists of Series N140F Pota-Pox Plus, a penetrating concrete primer, Series 215 Epoxy Surfer, a 100% solids epoxy bedding coat, with an embedded  $\frac{3}{4}$  ounce fiberglass mat, and a topcoat of Series 22 Epoxoline. This high performance lining system was developed specifically to provide long-lasting performance in both membrane filtration and MBR process tanks.

### Primer

Series N140F Pota-Pox® Plus  
3-6 Mils DFT

### Bedding Coat

Series 215 Surfacing Epoxy  
60-80 Mils DFT

### Reinforcement

Series 211-215 Fiberglass Mat

### Saturant Coat

Series 22 Epoxoline

### Topcoat

Series 22 Epoxoline  
20-30 Mils DFT

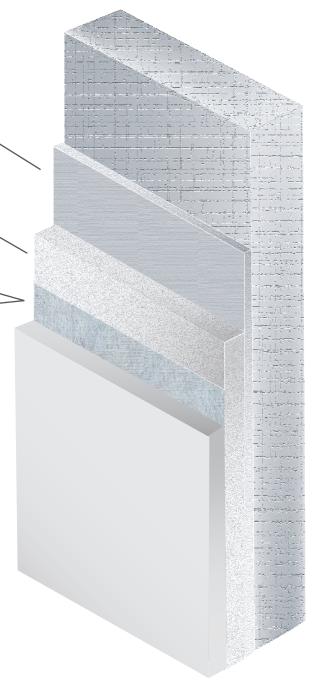

## THE RIGHT SYSTEM FOR YOUR PROJECT

For more information about Tnemec's Series 215ML/22 lining system, [contact](#) your local Tnemec representative. Our representatives are among the most tenured and knowledgeable experts in the industry and can help you understand the benefits of specifying and applying the ideal coating system on your structures.

Published technical data, instructions and pricing are subject to change without notice. Contact your Tnemec technical representative for current technical data, instructions and pricing. Warranty information: The service life of Tnemec's coatings will vary. For warranty, limitation of seller's liability and product information, please refer to Tnemec Product Data Sheets at [tnemec.com](http://tnemec.com) or contact your Tnemec technical representative. © Tnemec Company, Inc. 2022 FLYFILTER